

\$450,000

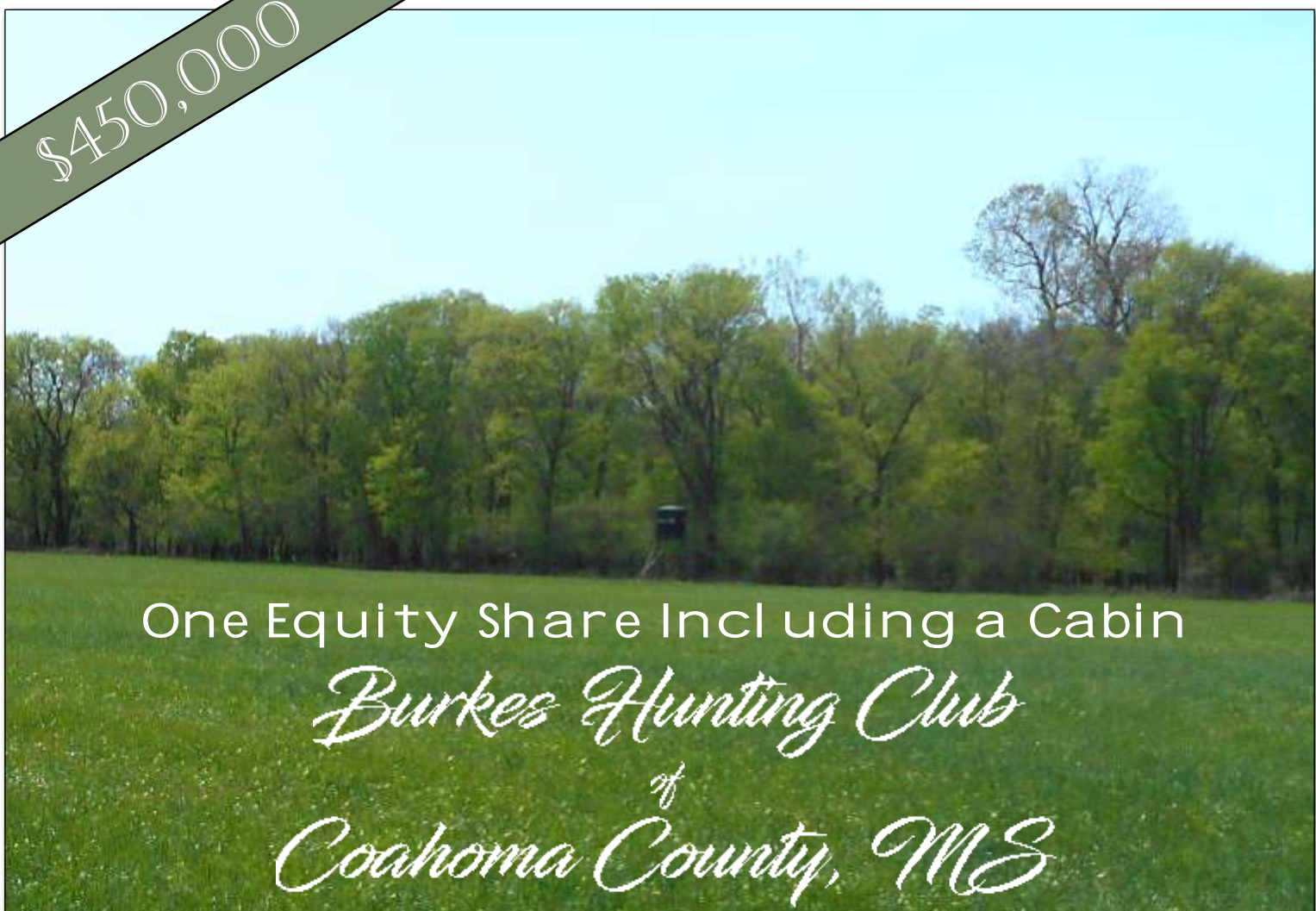

One Equity Share Including a Cabin

*Burkes Hunting Club
of
Coahoma County, MS*



call me today!

MICHAEL OSWALT, REALTOR®
Michael@TomSmithLand.com

601.898.2772 office | 662.719.3967 cell

601 Crescent Blvd., Suite 103 Ridgeland, MS 39157



Expect More. Get More.

TomSmithLandandHomes.com

Information is believed to be accurate but not guaranteed.

Burkes Hunting Club of Coahoma County, MS

- 7,000 ± Acres of MS River Hunting Land Inside the Mississippi River Levee — All Owned by the Club
- Cabin Included (3 Bedroom / 2 Bath/ Loft (Extra Bedroom) / Kitchen / Great Room / Screened Porch / Carport. Approximately 2,500 Square Feet—Completely Renovated after the 2011 Flood
- 35 Shares owned by 35 Members (Cannot own Multiple Shares)
- Annual Dues \$3,200 / No Debt on Club / No Lease on Cabin Lot
- Family Oriented—Wives and Kids Welcomed at all times!!
- Boat Ramp Access to MS River at Gate (Quapaw Landing—Public Landing)
- Shooting Range
- Top-Notch Hunting (Deer, Turkey, Hogs, and all Small Game - No Duck Hunting on Club)
- **Biggest Deer to Date Scored 185"**
- Multiple Blue Holes with Great Fishing
- Approximately 450 Acres of Annual Wildlife Plots
- Land Diversity (Mature Timber, Young Timber, Cutover, Food Plots, Lakes)
- Many Deer Stands Scattered throughout (Box Stands, Hang-On, Lean-To)
- Skinning Shed with Walk-in Cooler
- Fulltime Caretaker—Lonnie Stafford (10+ Years)
- Wildlife Biologist—John Barnell from Texas
- Membership Subject to Approval of Club (30 Day First Right of Refusal)

Children of Members over the age of 22 may pay dues and have all rights as their parent without buying a membership

Burkes Hunting Club was formed in 1971, and is considered a typical Mississippi River Equity Share Club. The hunting is some of the best our state has to offer, the cabins are nice, and the comradery is the best part. You will feel welcomed from day one. Whether you like to relax while letting your kids play with all the other kids and grandkids, sit by a fire watching towboats push barges down the river, or hunting some of the best land Mississippi has to offer, you will find it all here! Call Michael Oswalt today for your private tour!!



MICHAEL OSWALT, REALTOR®
Michael@TomSmithLand.com
601.898.2772 office | 662.719.3967 cell
601 Crescent Blvd., Suite 103 Ridgeland, MS 39157



TomSmithLandandHomes.com

Information is believed to be accurate but not guaranteed.



MICHAEL OSWALT, REALTOR®

Michael@TomSmithLand.com

601.898.2772 office | 662.719.3967 cell

601 Crescent Blvd., Suite 103 Ridgeland, MS 39157



Expect More. Get More.



TomSmithLandandHomes.com

Information is believed to be accurate but not guaranteed.



MICHAEL OSWALT, REALTOR®

Michael@TomSmithLand.com

601.898.2772 office | 662.719.3967 cell

601 Crescent Blvd., Suite 103 Ridgeland, MS 39157



Expect More. Get More.



TomSmithLandandHomes.com

Information is believed to be accurate but not guaranteed.



MICHAEL OSWALT, REALTOR®
 Michael@TomSmithLand.com
 601.898.2772 office | 662.719.3967 cell
 601 Crescent Blvd., Suite 103 Ridgeland, MS 39157



Expect More. Get More.

TomSmithLandandHomes.com

Information is believed to be accurate but not guaranteed.



MICHAEL OSWALT, REALTOR®

Michael@TomSmithLand.com

601.898.2772 office | 662.719.3967 cell

601 Crescent Blvd., Suite 103 Ridgeland, MS 39157



Expect More. Get More.

TomSmithLandandHomes.com

Information is believed to be accurate but not guaranteed.

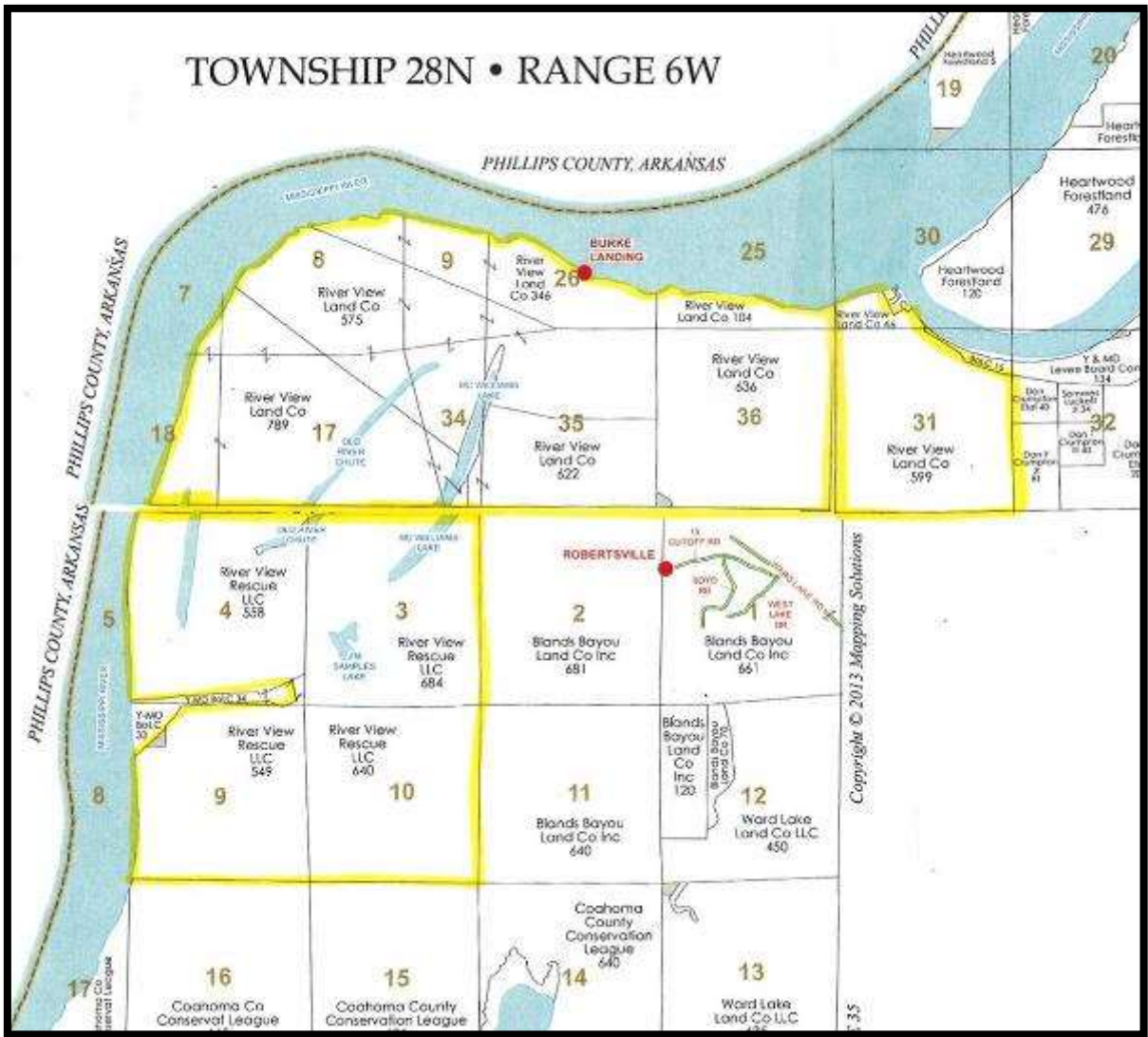

Ownership Map

MICHAEL OSWALT, REALTOR®

Michael@TomSmithLand.com

601.898.2772 office | 662.719.3967 cell

601 Crescent Blvd., Suite 103 Ridgeland, MS 39157



Expect More. Get More.



TomSmithLandandHomes.com

Information is believed to be accurate but not guaranteed.



Aerial Map
Click [HERE](#) for an Interactive Map



MICHAEL OSWALT, REALTOR®
Michael@TomSmithLand.com
601.898.2772 office | 662.719.3967 cell
601 Crescent Blvd., Suite 103 Ridgeland, MS 39157



TomSmithLandandHomes.com

Information is believed to be accurate but not guaranteed.

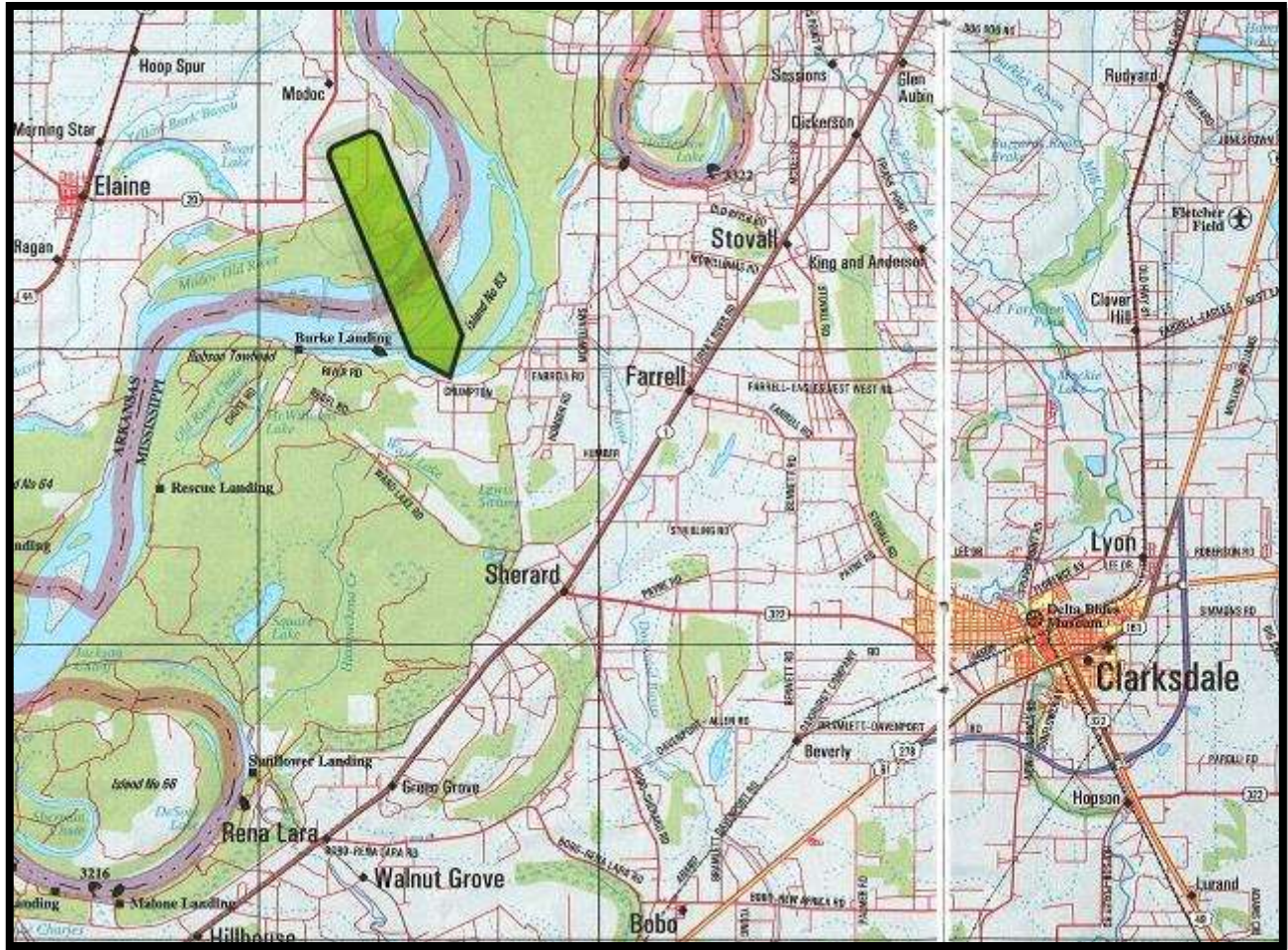

DIRECTIONAL MAP

DIRECTIONS: From the Intersection of Highway 1 and Highway 322 west of Clarksdale, MS, travel Highway 1 north 4.15 miles, travel Farrell Road west 4.36 miles, you will dead end at the gate.

MICHAEL OSWALT, REALTOR®
 Michael@TomSmithLand.com
 601.898.2772 office | 662.719.3967 cell
 601 Crescent Blvd., Suite 103 Ridgeland, MS 39157



TomSmithLandandHomes.com

Information is believed to be accurate but not guaranteed.